



# nyloprint<sup>®</sup> Combination CW 35 x 50

Mid-size compact all-in-one letterpress plate making system

Mid-size unit of the equipment combinations, suitable for processing water washable printing plates up to a maximum size of 300 x 500 mm (13.8" x 19.7")

## High efficient and cost effective

- includes exposure, washout and drying unit for the production of high quality water washable letterpress plates
- space saving as all units can neatly be stacked on a trolley base
- each component can be (purchased and) used separately, as each has its own electrical connection
- long service life due to advanced materials – the casing of the equipment and all parts in contact with water are made of high quality stainless steel
- process safety due to programmed plate processing parameters and temperature controlled washout section
- for washout only tap water is needed
- less mechanical stress due to a proven plush washout system that prevents the washing away of fine elements
- oscillating plate holder ensures even plate washout and is self adjusting to allow the use of different plate thicknesses

## Simple operating and convenient handling

- digital programmable operating panels for customising the processing times of each function
- audio alarm to signal end of each process
- trolley base with casters for easy movement and access to the system
- separate units for each process allows to easily replace or upgrade one part of the system if necessary

# nyloprint® Combination CW 35 x 50

## Equipment dimensions

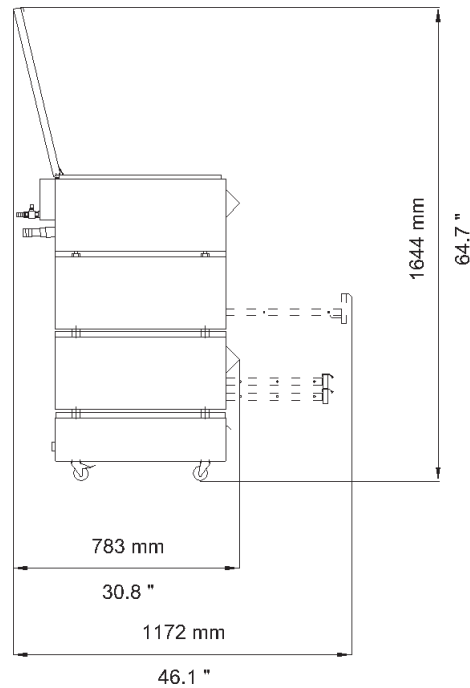
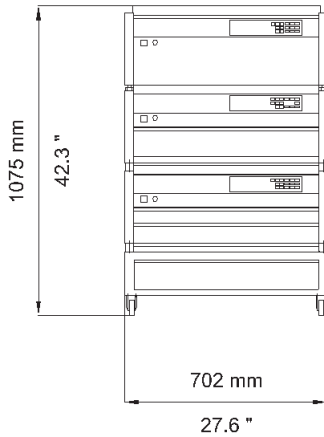

Technical data	Exposure	Washer	Dryer	Trolley
<b>Max. plate size (W x L)</b>	<b>350 mm x 500 mm (13.8" x 19.7")</b>			
<b>Electrical connection</b>	230 V, 50 Hz (1 Ph/N/PE) 230 V, 60 Hz (1 Ph/N/PE)	230 V, 50/60 Hz (1 Ph/N/PE)	230 V, 50/60 Hz (1 Ph/N/PE)	230 V (AC)
<b>Nominal current</b>	3.5 A / 3.3 A	4.5 A	2.2 A	-
<b>Nominal power</b>	0.5 kW	1.0 kW	0.6 kW	2.1 kW
<b>Exposure tubes</b>	8 pcs., TL 40 W 10R (UV-A)	-	-	-
<b>Fresh water connection</b>	-	R 3/8"	-	-
<b>Waste water connection</b>	-	Ø 25 mm (0.984")	-	-
<b>Dryer</b>	-	-	2 drawers, heating element 500 W	-
<b>Weight (approx.)</b>	53 kg (116 lbs) net 69 kg (152 lbs) gross	53 kg (116 lbs) net 69 kg (152 lbs) gross	48 kg (106 lbs) net 64 kg (141 lbs) gross	25 kg (55 lbs) net 30 kg (66 lbs) gross
<b>Crate dimensions (W x D x H)</b>	870 x 800 x 495 mm (34.3" x 31.5" x 19.5")	870 x 800 x 495 mm (34.3" x 31.5" x 19.5")	870 x 800 x 495 mm (34.3" x 31.5" x 19.5")	800 x 750 x 298 mm (31.5" x 29.5" x 11.7")

You are welcome to contact us for further information.

**Flint Group Germany GmbH**  
Sieglestrasse 25  
70469 Stuttgart  
Germany

T +49 711 9816-301  
F +49 711 9816-801  
info.flexo@flintgrp.com  
www.flintgrp.com

All information in this document is based on our present knowledge and experience at the time of printing. Due to the multitude of factors influencing the processing and application of our products, it does not exempt the user from testing and calibrating. Nor does it imply any legally binding assurance concerning specific properties of the products or the suitability for a particular application. The responsibility of observing any possible industrial property rights, laws and regulations is the obligation of the user. Subject to technical changes without prior notice. Product names marked ® are registered trademarks of Flint Group.